

# PRODUCT INFORMATION PACKET

Model No: 180L4B3NM

General Purpose IEC Motor, 30 HP, 3 Ph, 50 Hz, 380/660 V, 1475 RPM, Frame 180L, TEFC

# NEWMAN

TRUST IS POWER



Newman Motors is a trademark of Newman Industrial Company LLC.  
©2023 Newman Motors Company, All Rights Reserved



### Technical Specifications

Output HP	30 Hp	Output KW	22 kW
Frequency	50 Hz	Voltage	380VD / 660VY
Rated Current	42.9 / 24.7 A	Speed	1475 rpm
Service Factor	1.0	Phase	3
Efficiency 100%	91.6 %	Power Factor 100%	0.85
Starting Current	7.7	Number of poles	4
Starting Torque	2.1	Rated Torque	142.2 Nm
Frame Size	180L	Enclosure	Totally Enclosed Fan Cooled
Duty	S1= Continuous	Insulation Class	155 (F) / 130 (B)
Explosion Protection	Without (Standard)	Efficiency Class	IE2
Thermal Protection	Without	Direction of Rotation	Bidirectional
Drive End Bearing Size	6311 C3 RZ	Opp Drive End Bearing Size	6311 C3 RZ
Drive End Bearing	Ball	Opp Drive End Bearing	Ball
Vibration Class	A (Standard)	Terminal Box Position	Terminal Box on Left
Method of Cooling	IC411	Weight	195
Type of Construction	IMB3	RAL Color	9005
Altitude About Sea Level	1000 m	Ambient Temperature	40 °C
Motor Orientation	Horizontal	Paint Class	C2 (Standard)
IP Code	55	Frame Material	Cast Iron
Shaft Diameter	48mm	Overall Length	110mm

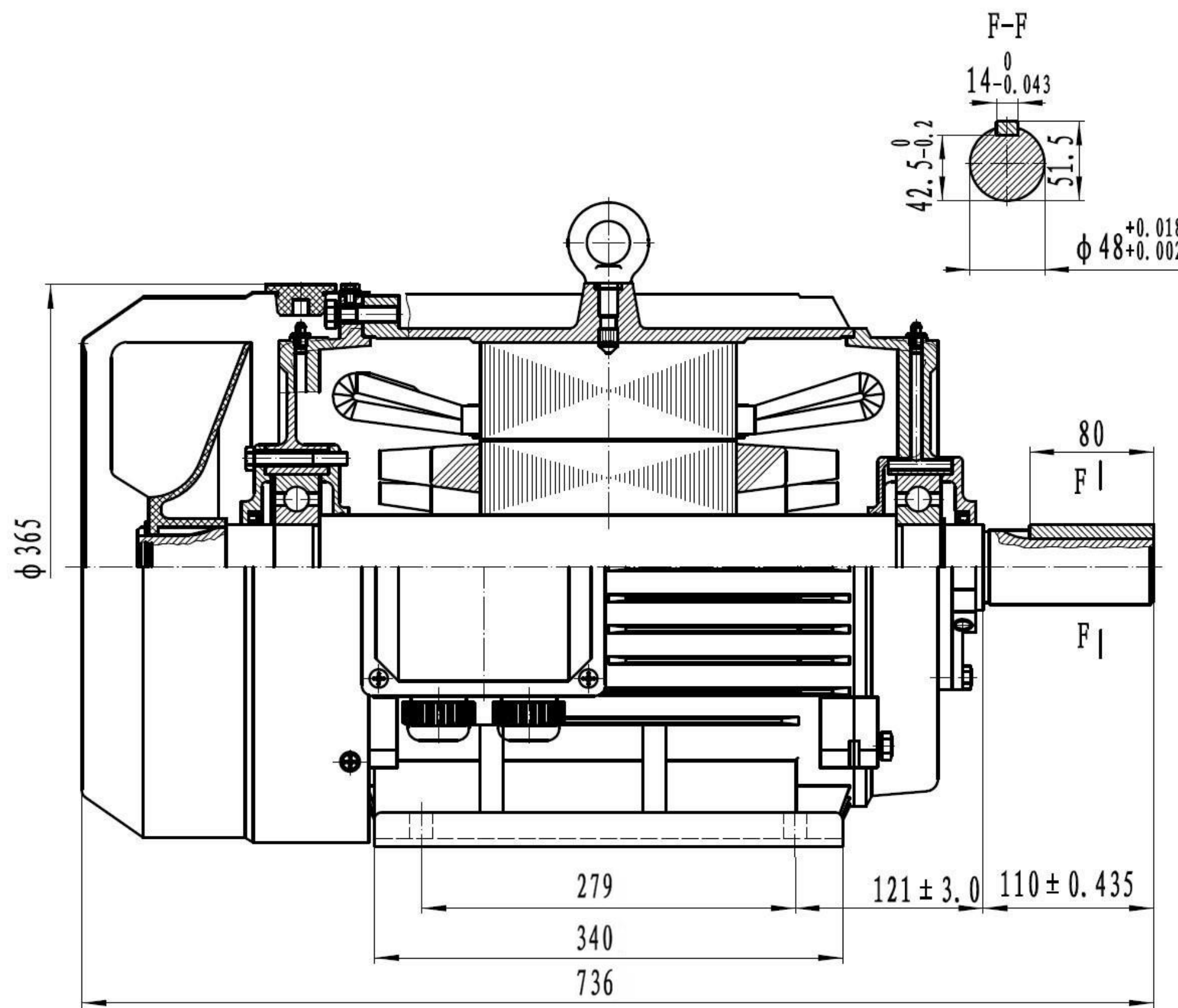
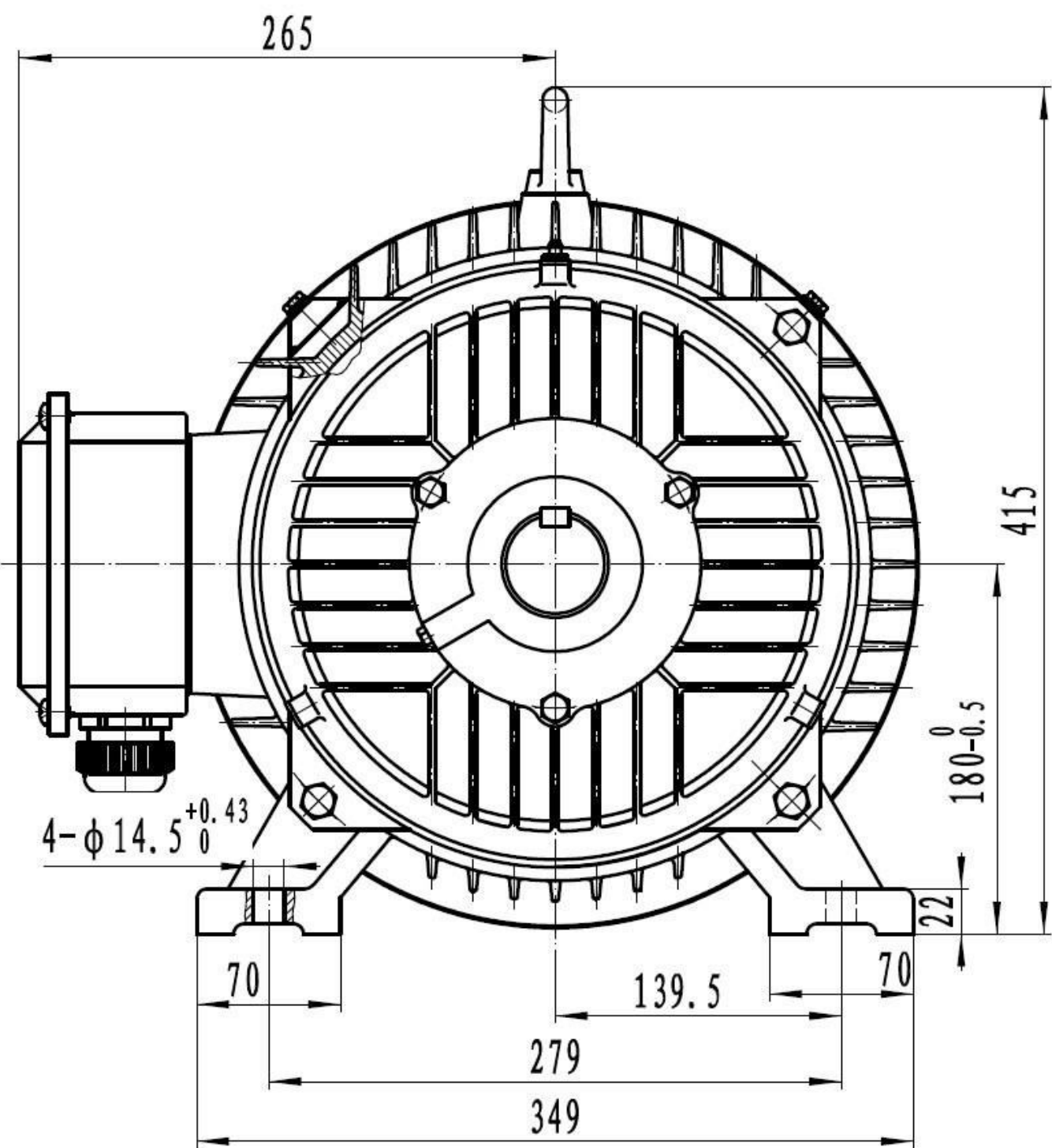

				B3 Left Side Box			180L4B3NM IP 55	
CHK D.		DATE						
APP D.		DATE		WEIGHT (KG)	195	SCALE	1:3.5	
							IM B3	

# Curve Torque (M/NM) vs Slip

**180L4B3NM 30 HP, 3 Ph, 50 Hz, 380/660 V, 1475 RPM, Frame 180L, TEFC**  
Breakdown Torque: 3.269 - Slip: 0.18 // Rated Torque (NM): 142.2 Nm

